

電動車充電樁分別計費專用電度錶(24x48mm)

(SPECIAL WATT-HOUR METER FOR SEPARATE BILLING OF ELECTRIC VEHICLE CHARGING PILES), 24X48mm

MODEL
MMS-PWH



■特點(FEATURES)

- 精確度±0.2%滿刻度(Accuracy ±0.2% F.S.)
- 可同時量測與顯示交流電壓/電流/仟瓦特/仟瓦特小時/功率因數 (Measuring and display ACV/ACA/KW/KWH/Power Factor)
- 交流電壓/電流/瓦特皆為真正有效值(TRMS)(ACV/ACA/KW for True RMS)
- 突波測試強度4仟伏特(1.2x50us)(Surge test 4KV(1.2x50us.))
- 數位RS-485界面(Digit RS-485 interface function)
- 尺寸小(24x48x48.5mm),穩定性高(Dimension small(24x48x48.5mm) and High stability)
- 分離式端子,配線容易(Discrete terminal,connector easy)

1. MODEL: MMS-PWH

(選購型號)

NO	Input Current	NO	Input Current
1	AC0~5.000A(Built-in)	3	CT(AC0~50.00A)
2	CT(AC0~5.000A)	9	SPECIFIED

2. SPECIFICATION (主要規格)

- Measuring accuracy (精確度): ±0.2% F.S. (rate) (V/A/KW/KWH/P.F) (23±5°C)
- Input burden (輸入負載): <0.7VA (Voltage & Power supply) <0.25VA (Current)
- Maximum input over (最大過載能力): Current related input: 3 x rated continuous, 10 x rated 30 sec, 25 x rated 3 sec, 50 x rated 1sec
Voltage related input: Maximum AC300V continuous
- Measuring and display range (量測與顯示範圍): Voltage (AC) 80.0~250.0V
Current (0.00~5.000/50.00A)
Watt (0~1.2500/12.500KW)
KWH (0~99.999/999.99/9999.9/99999KWH auto-range)
Power factor (1.000~0.500 PF)
- Over input indication (過載顯示): "OVER" & "Unit indication"
- Sampling time (取樣時間): 1 cycles/sec.
- Display mode (顯示模式): Auto or manual can be selective (Auto: change page/5 second)
- RS-485 address (通訊位址): "00" ~ "FF" (0~255)
- RS-485 baud rate (傳輸速度): 19200/9600/4800/2400 selective
- RS-485 protocol (通信協議): Modbus RTU mode
- Temp. coefficient (溫度係數): 50ppm/°C (0~50°C)
- Display (顯示幕): Red high efficiency LEDs high 6.8mm (0.268")
- Parameter setting (參數設定方式): Touch switches
- Memory mode (記憶型式): Non-volatile E²PROM memory
- Dielectric strength (絕緣耐壓能力): 2KV_{ac}/1 min. (input/case)
- Surge test (突波測試): ANSI c37.90a/1974, DIN-IEC 255-4 impulse voltage 4KV (1.2x50us)
- Operating condition (使用環境條件): 0~50°C (20 to 90% RH non-condensed)
- Storage condition (存放環境條件): 0~70°C (20 to 90% RH non-condensed)
- CE EMC Certification (CE 認證): EN 55022:1998/A1:2000 Class A
EN 61000-3-2:2000
EN 61000-3-3:1995/A1:2001
EN 55024:1998/A1:2001

3. OUTSIDE DIMENSION AND CONNECTION DIAGRAM

(外型尺寸與開孔尺寸與配線圖)

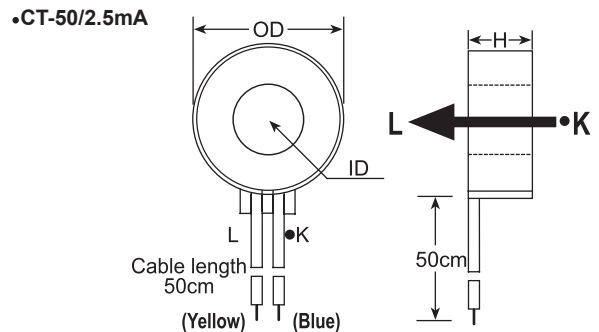
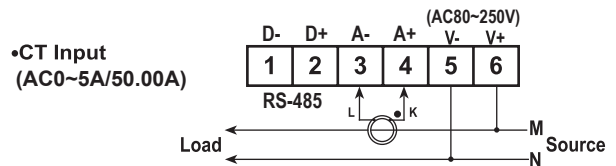
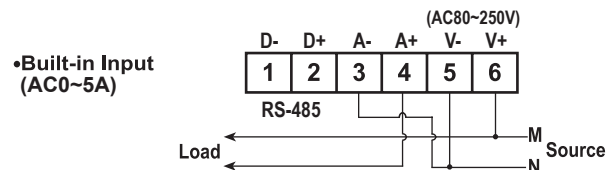
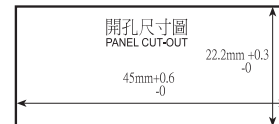
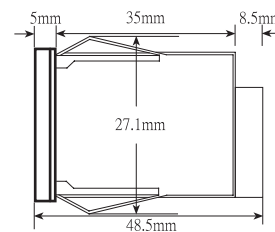
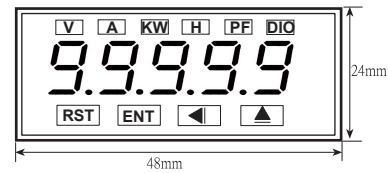

• CT-50/2.5mA: OD/ID/H=26/8.0/13.5mm